

THESE PLANS ARE APPROVED FOR CONFORMANCE WITH THE CITY OF KENT ENGINEERING DIVISION'S REQUIREMENTS.

APPROVED BY: _____
DATE APPROVED: _____

DAVID A. CLARK ARCHITECTS, PLLC

33017 134th AVENUE SE
AUBURN, WASHINGTON
98092-8519
TEL 253 351-8877
FAX 253 804-6566
www.ClarkArchitects.com
© 2009 DAAC. ALL RIGHTS RESERVED

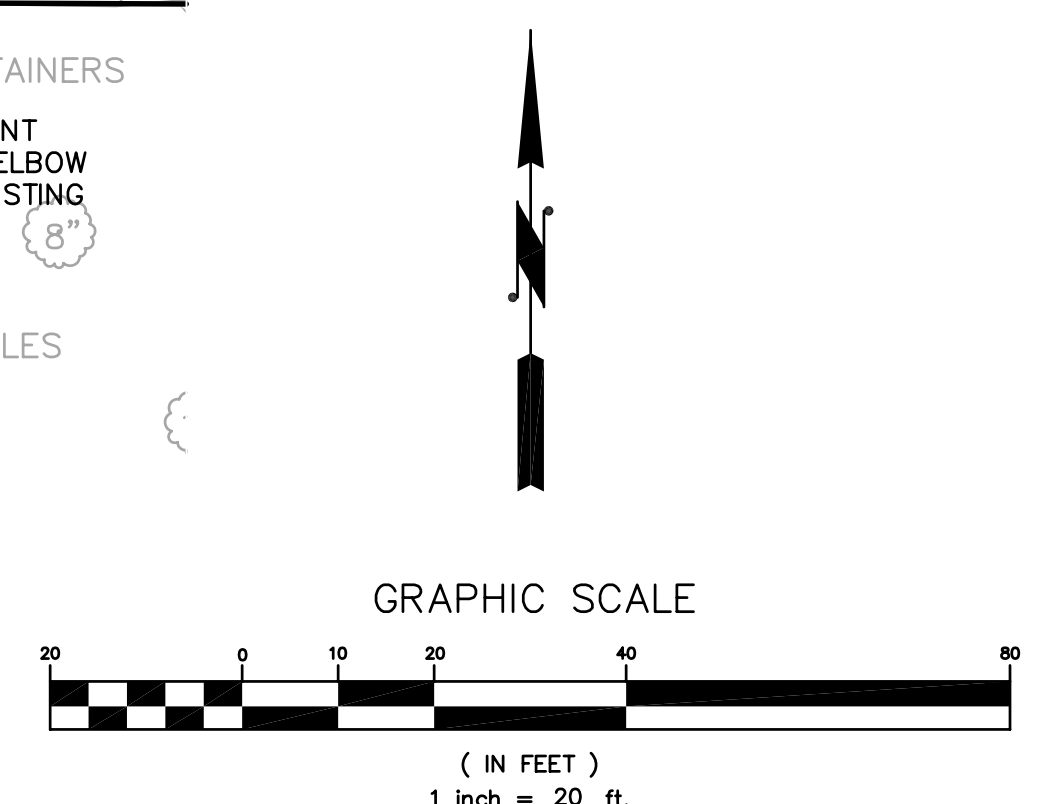
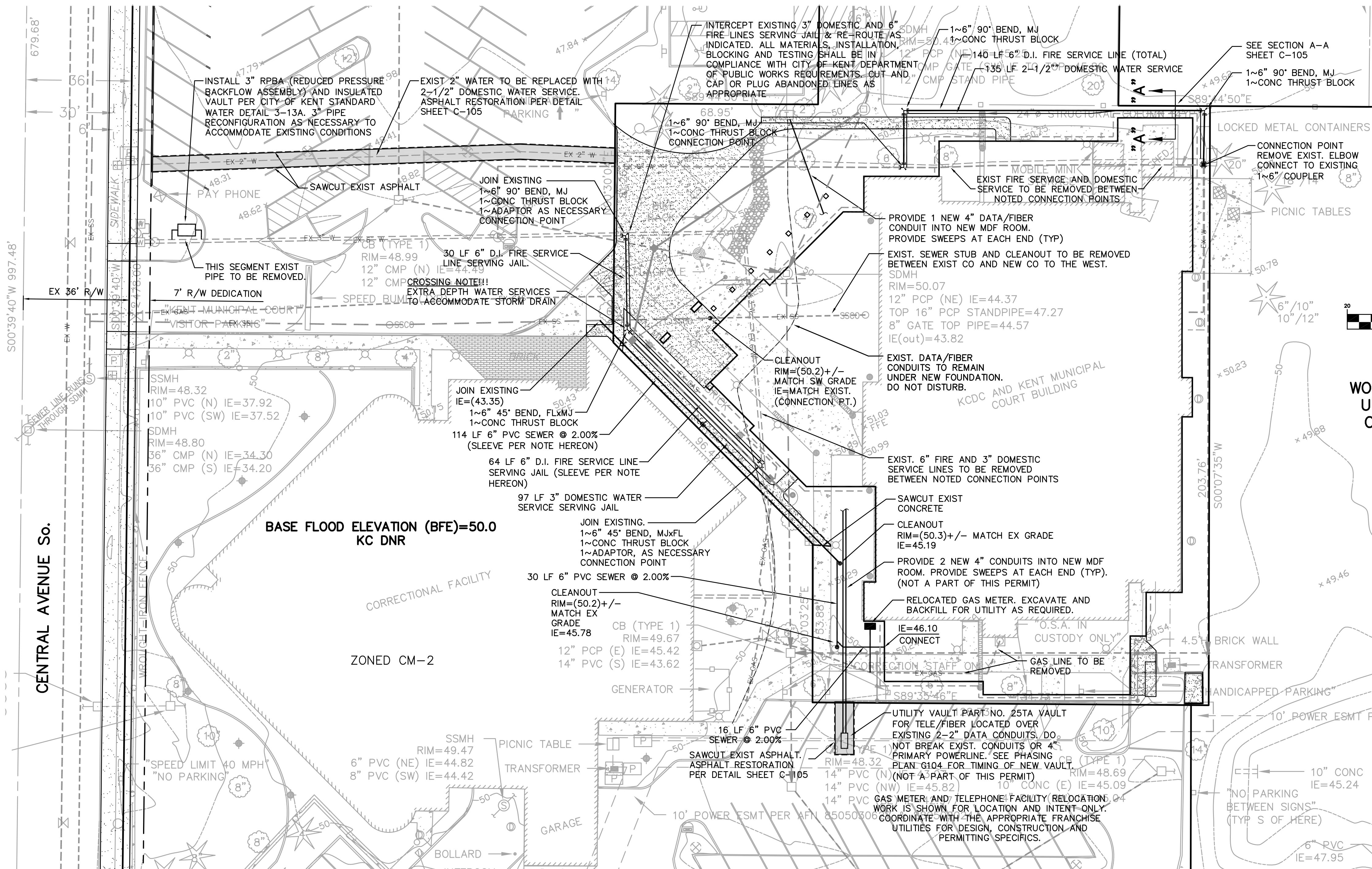

WORK TO BE DONE BY LEVEL III OR U STATE CERTIFIED CONTRACTOR CONCRETE THRUST BLOCKS PER TABLE HEREON

NOTE: ALL EXISTING TOPOGRAPHIC INFORMATION SHOWN HEREON WAS TAKEN FROM A SURVEY PREPARED BY CHS ENGINEERS, LLC, JOB No. 600830, DATED 12-30-08. SOUND CONSULTANTS, LLC, ASSUMES NO RESPONSIBILITY FOR THE ACCURACY OR COMPLETENESS OF THAT EXISTING INFORMATION. THE CONTRACTOR SHALL VERIFY, AS FIRST ORDER OF CONSTRUCTION, THE HORIZONTAL AND VERTICAL LOCATIONS OF ALL CRITICAL POINTS OF CONNECTION AND IMMEDIATELY NOTIFY THE OWNER AND/OR ENGINEER OF ANY SIGNIFICANT DISCREPANCY WHICH WOULD PREVENT THE CONSTRUCTION OF THAT DEPICTED HEREON.

NOTE: FIRE PREVENTION AND DOMESTIC WATER SERVICES NOT TO BE SHUT DOWN FOR MORE THAN A FOUR (4) HOUR PERIOD FOR CONSTRUCTION. CONTRACTOR TO COORDINATE WITH PROJECT MANAGER.

Pipe Diameter (inches)	Horizontal Bend (degrees)	Test Pressure (PSI)	Soils Bearing Pressure (PSF)	Thrust (LFt)	Thrust Block Surface Area (SF)	Recommended Thrust Block Height (ft)	Recommended Thrust Block Width (ft)
6	90	230	2000	12,162	9.10	2	4.60
6	45	230	2000	6,813	5.10	2	2.60
2 1/2 TO 3	90	230	2000	12,162	3	1.50	2.00
2 1/2 TO 3	45	230	2000	6,813	1.20	1	1.20

Water Main Concrete Thrust Block Sizing based on 2007 NFPA Pgs. 13-298 to 13-300 City of Kent Water Main Specifications Section 3.8.7 Pressure and leakage tests shall be per WSDOT APWA std spec WSDOT std spec 7-09.3(23) requires pressure test of 150 psi greater than operating pressure. Operating pressure static shut in pressure reported at 80 psi. Soil bearing strength based on URS geotech report for site, 2000 psi Which is conservative compared to 2007 NFPA Table A.10.8.2(b) For sandy silt.

CASING PIPE NOTE:
PROVIDE 6" CASING PIPES FOR 2.5 INCH WATER MAINS, AND A 12" CASING PIPE FOR 6" AND 8" SEWER AND WATER MAINS. CASING PIPE SHALL BE AWWA C900 FOR CASING UP TO 12" DIAMETER. JOINTS MUST MEET AWWA (ASTM D3139 OR F477). PRESSURE TEST INSTALLED CASING PIPE AT 150 PSI PER DOE CRITERIA FOR SEWAGE WORKS DESIGN."



OWNER
City of Kent Facilities
220 - 4th Avenue South
Kent, WA 98092

PROJECT
Kent District Court Expansion
1210 Central Avenue South
Kent, WA 98032

JOB NUMBER
2009011.00

DRAWN BY
JVH

CHECKED BY
HEH

DATE DRAWING CREATED
April 21, 2009

CURRENT DRAWING DATE
November 17, 2009

REVISIONS & PRINT ISSUE DATES

11-17-09 - REVISION #1
REVISED PER CITY COMMENTS

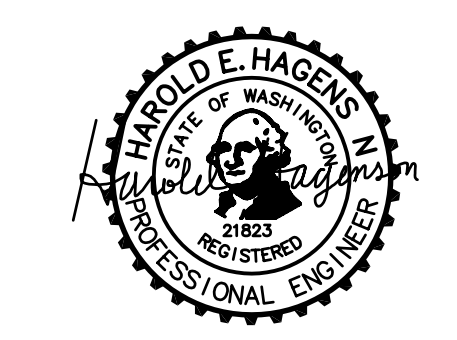

11-06-09

DRAWING TITLE
PRIVATE FIRE MAIN PERMIT

SCALE
1"=20'

DRAWING NUMBER
C-104

DRAWING ISSUED FOR
FOR PERMIT

